



Mobi-C[®]

CERVICAL DISC PROTHESIS

Plug & Fit



Mobi-C[®]

Plug & Fit

Resulting from years of clinical experience and close collaboration with a group of surgeons specializing in the spine, LDR has made another innovative step forward by equipping their Mobi-C cervical prosthesis with a **new, unique implantation system, reliable and patented: the "Plug & Fit" technology.**

This evolution of the Mobi-C provides you with an ease of use and modularity unequalled in the domain of cervical arthroplasty while preserving the core philosophy of the Mobi-C: Restoration of physiological biomechanics with a controlled mobility insert.



Mobi-C[®] new generation is:

Enhanced reliability:

No intra-operative handling of the implant, Mobi-C is delivered assembled and maintained between two clamps. This new sterile packaging guarantees minimal, but controlled, handling of the implant while shortening operating time.

Secure control:

The clamps made of PEEK-Classix[®], for one-time use, are radio-transparent in order to optimize and simplify intra-operative control of implant positioning. In addition, they ensure perfect control of the implant in rotation before releasing.

Simplified instrumentation:

The Mobi-C "Plug & Fit" instrumentation was entirely redesigned in order to provide a single implant holder compatible with all implant sizes. Its new ergonomics renders implantation more intuitive while still conserving the benefits of millimetric adjustment for optimal and controlled positioning of the prosthesis.

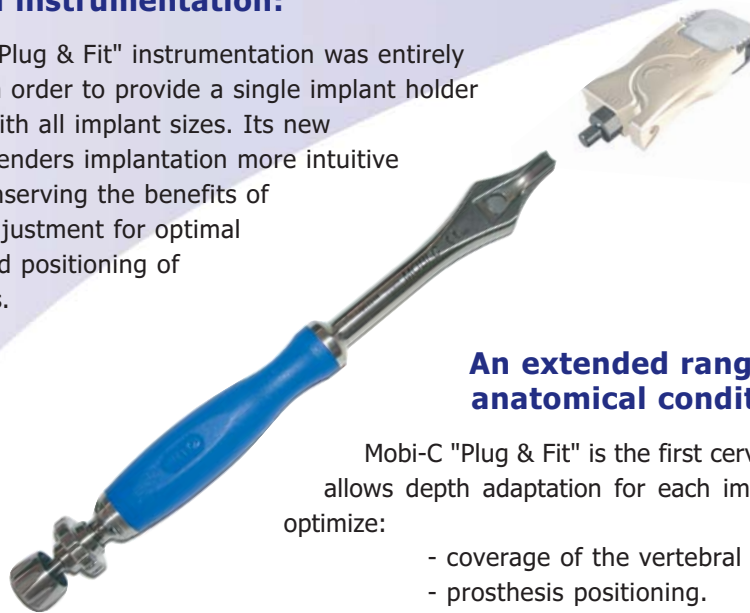

An extended range, adapted to anatomical conditions:

Mobi-C "Plug & Fit" is the first cervical disc prosthesis that allows depth adaptation for each implant width in order to optimize:

- coverage of the vertebral endplates and,
- prosthesis positioning.

The new posterior chamfers simplify implantation and help diminish the risks of secondary impaction.

Innovation at the service of simplicity

Simplified surgical technique: Approach: identical to that of a classic anterior arthrodesis

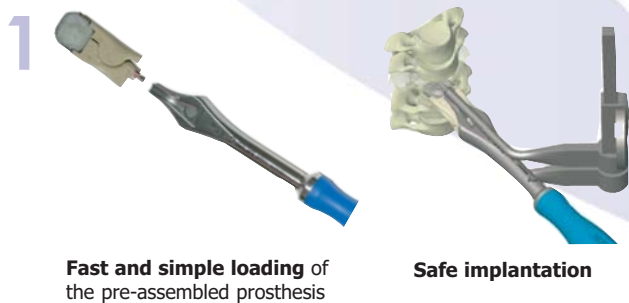

1 Fast and simple loading of the pre-assembled prosthesis

2 Safe implantation

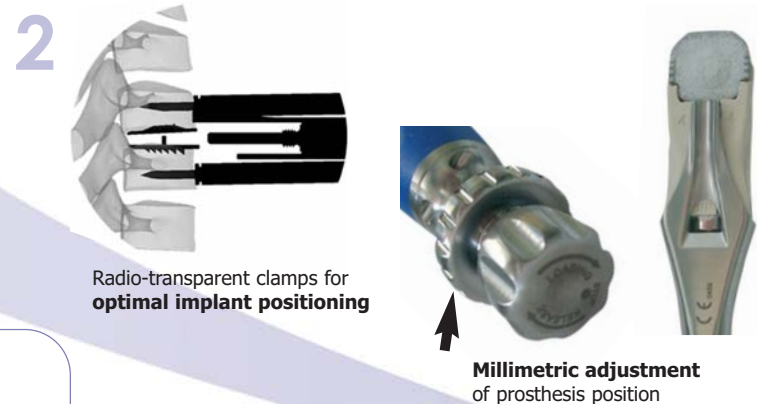

3 Radio-transparent clamps for optimal implant positioning

4 Millimetric adjustment of prosthesis position

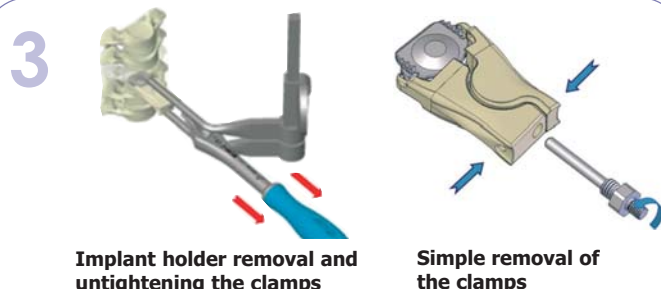

5 Implant holder removal and untightening the clamps

6 Simple removal of the clamps



www.ldrmedical.com

France

Technopôle de l'Aube BP 2
10902 Troyes Cedex 9
France
+33 (0)3 25 82 32 63

China

Beijing Global Trade Center #36
North Third Ring Road East,
Unit 06, Level 19, Building A,
Dongcheng District,
Beijing, China, 100013
+86 10 58256655

Brazil

Av. Pereira Barreto, 1395
Torre sul - CJ 193 - Bairro Paraíso
Santo André - São Paulo
CEP: 09190-610
Brazil
+55 11 43327755

United States

4030 West Braker Lane, Suite 360
Austin, Texas 78759
512.344.3333

LDR, LDR Spine, LDR Médical, BF+, BF+(ph), Easyspsine, Laminotome, MC+, Mobi, Mobi-C, Mobi-L, Mobidisc, ROI, ROI-A, ROI-C, ROI-MC+ and ROI-T are trademarks or registered trademarks of LDR Holding Corporation or its affiliates in France, the United States and other countries.